

## LIMITED LIFETIME WARRANTY

This product is warrantied against defects in materials and workmanship, provided that:

1. The product was installed according to the product instructions.
2. Pro Design LLC recommendations were followed regarding limitations and specifications of the product.

Pro Design LLC reserves the right to determine if your shade warrants a repair or partial replacement of any parts. If necessary, Pro Design LLC will replace your shade with a new shade of equal or superior value. This shall be your sole remedy under this warranty.

This Limited Lifetime Warranty excludes all motors, controls and accessories that are warrantied for only a period of five years from the date of purchase. Failure to follow the proper installation, charging and use instructions will invalidate the warranty for motors, remotes, wands and hubs.

This Limited Lifetime Warranty applies only to the original retail purchaser with proof of purchase.

This Limited Lifetime Warranty does not cover the removal or installation of original or replacement shades. This Limited Lifetime Warranty does not cover damage or defects caused by, or resulting from improper maintenance, neglect or improper use, wear and tear, abuse, neglect, accidents, alteration, commercial use, installation, removal or reinstallation or exposure to excessive moisture.

### Your Rights Under State Law

These warranties give you specific legal rights. You may also have other rights which may vary from State to State. In no event shall Pro Design LLC be liable for incidental or consequential damages or for any other direct or indirect damage, loss, cost, expense or fee. Some states do not allow the exclusion or limitation of incidental or consequential damages, so the above limitation or exclusion may not apply to you. These warranties are exclusive and in lieu of all other obligations, liabilities, disclaimers or warranties.

## LIMITED NO QUESTIONS ASKED WARRANTY

The Pro Design LLC Limited "No Questions Asked" Warranty is offered exclusively to Budget Blinds' customers purchasing products from the Inspired Shades Collections only. This warranty allows a one-time complimentary replacement or repair should a shade become damaged or inoperable after the initial installation.

This warranty is valid for five years from the original date of purchase. Replacement or repair will be at Pro Design LLC's discretion.

The replacement shade will be made to the same size and specifications as the original shade. The replacement shade must be ordered in the same pattern and color. If the original pattern or color is not available, the shade will be replaced with the closest available option. If a shade is replaced, there may be variations in the color or texture of the original and replaced shades.

This warranty does not cover motors or batteries for motorized shades. This warranty does not cover trip charges or labor charges for removal or installation. This warranty is provided to the original purchaser only with proof of purchase and does not cover damage caused by removal, storage or reinstallation of the shades. This warranty is only available through Budget Blinds® franchisees.



# INSTALLATION INSTRUCTIONS: FOLDING DOOR

Thank you for purchasing your custom folding door. With proper installation, your folding door should look beautiful and provide years of service. Please read these instructions before starting installation.

**TOOLS REQUIRED:** Pencil, Tape Measure, Screw Driver, Step Stool, Level, + Drill

**NOTE:** For wallboard or plaster, use anchors designed for hollow walls (not included). For concrete, stone and brick, use a masonry drill bit and anchors designed for masonry (not included).

**OPTION A:** Outside / Wall Mount Without Valance

**OPTION B:** Outside / Wall Mount With Valance

**OPTION C:** Inside / Ceiling Mount Without Valance

**OPTION D:** Inside / Ceiling Mount With Valance

### OPTION A: OUTSIDE / WALL MOUNT WITHOUT VALANCE

**1:** Determine height to position brackets. Once installed, the folding door should be 1/2" to 3/4" above the ground, so add this to the total ordered height of the folding door. Make sure there is enough clearance from the wall, so that the door will move freely past any obstructions. The door needs 2 1/2" clearance from the window trim or any other obstruction.

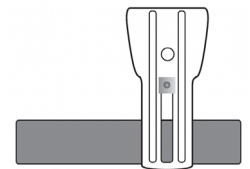

Figure 1

**2:** Position one bracket about 1" – 2" in from each end of the track. [Figure 1] Mark screw holes with a pencil and drill pilot holes. [Figure 2] Use appropriate wall anchors. Position the other brackets equally across the width of the door. Make sure all brackets are straight and level.

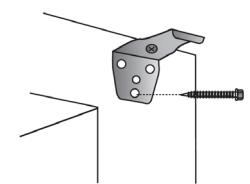

Figure 2

**3:** Angle the track into the brackets by first placing the back lip of the track under the plastic carrier and then pushing the front lip of the track into place under the front angle of the bracket. [Figure 3]

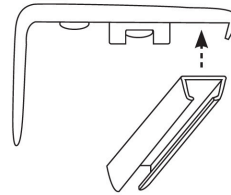

Figure 3

**4:** Slide the hangers on top of the folding door into the track so that the folding door hangs from the track. Do not insert the hanger on the top of the bamboo edge bar that will be at the stationary side.

**5:** Install one set screw about 1" from the end of the track where the stationary bamboo edge bar will be located. Insert the hanger on the bamboo edge bar and then install another set screw at the end of the track, so the bamboo edge bar is caught between the two set screws and cannot move. If installing a split draw door, the bamboo edge bar at each end will require two set screws to hold it in place. [Figure 4]

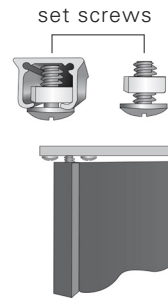

Figure 4

**6:** Install a set screw at the end of the opposite side of the track. The folding door can now slide freely without falling out of the track and the stationary end will not move.

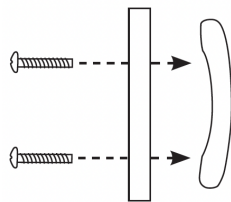

Figure 5

**7:** Install handle if desired. [Figure 5]

### OPTION B: OUTSIDE / WALL MOUNT WITH VALANCE

**1:** Install the brackets as steps 1 - 2 in Option A.

**2:** Install the track as step 3 in Option A.

**3:** Valance boards come with velcro attached to the front of the board that holds the valance in place. Place the valance board on top of the brackets and secure to the brackets by screwing a 3/4" screw into the valance through the hole in the top of the bracket. [Figure 6]

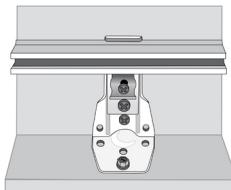

Figure 6

**4:** Install the folding door hangers and install the set screws as steps 4 - 6 in Option A.

**5:** Attach the valance to the front of the valance board. [Figure 7]

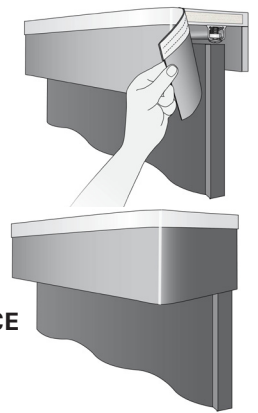

Figure 7

### OPTION C: INSIDE / CEILING MOUNT WITHOUT VALANCE

**1:** For ceiling mount, the same bracket can be used by removing the adjustable plate from the wall bracket. To remove this plate, unscrew the silver screw holding the two parts of the bracket together. [Figure 8]

Remove the screw and bolt. The flat plate can then be used as a ceiling bracket and installed to the mounting surface by screwing through the hole in the plate. [Figure 9]

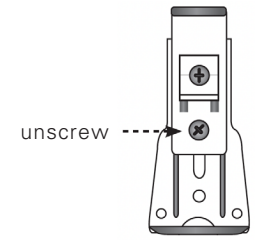

Figure 8

**2:** Locate the positions of the ceiling mount brackets and mark the screw holes. The track should be at least 2 1/2" in from the window or any obstruction that will stop the door moving freely. Make sure the brackets are aligned and straight. Drill pilot holes and insert appropriate wall anchors. Install brackets.

**3:** Install the track as step 3 in Option A.

**4:** Install the folding door as step 4 - 6 in Option A.

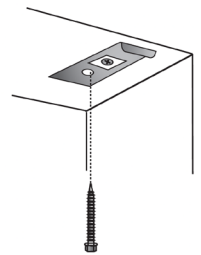

Figure 9

### OPTION D: INSIDE / CEILING MOUNT WITH VALANCE

**1:** Install the valance board to the ceiling with screws and the appropriate anchors. [Figure 10]

**2:** Install the brackets as in steps 1 - 2 of Option C.

**3:** Install the track and folding door as in steps 4 - 6 in Option A.

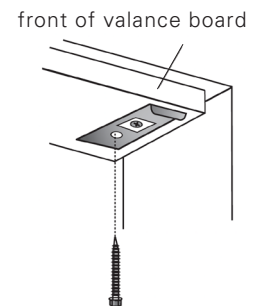

Figure 10