

INSPIRED SHADES™ COLLECTION LIMITED WARRANTIES



Limited No Questions Asked Warranty

The Pro Design LLC Limited “No Questions Asked” Warranty is offered exclusively to Budget Blinds’ customers purchasing products from the Inspired Shades Collections only. This warranty allows a one-time complimentary replacement or repair should a shade become damaged or inoperable after the initial installation.

This warranty is valid for five years from the original date of purchase. Replacement or repair will be at Pro Design LLC’s discretion.

The replacement shade will be made to the same size and specifications as the original shade. The replacement shade must be ordered in the same pattern and color. If the original pattern or color is not available, the shade will be replaced with the closest available option. If a shade is replaced, there may be variations in the color or texture of the original and replaced shades.

This warranty does not cover motors or batteries for motorized shades. This warranty does not cover trip charges or labor charges for removal or installation.

This warranty is provided to the original purchaser only with proof of purchase and does not cover damage caused by removal, storage or reinstallation of the shades. This warranty is only available through Budget Blinds franchisees.

Limited Lifetime Warranty

This product is warranted against defects in materials and workmanship, provided that:

1. The product was installed according to the product instructions.
2. Pro Design LLC recommendations were followed regarding limitations and specifications of the product.

Pro Design LLC reserves the right to determine if your shade warrants a repair or partial replacement of any parts. If necessary, Pro Design LLC will replace your shade with a new shade of equal or superior value. This shall be your sole remedy under this warranty.

This Limited Lifetime Warranty excludes all motors, controls and accessories that are warranted for only a period of five years from the date of purchase. Failure to follow the proper installation, charging and use instructions will invalidate the warranty for motors, remotes, wands and hubs.

This Limited Lifetime Warranty applies only to the original retail purchaser with proof of purchase.

This Limited Lifetime Warranty does not cover the removal or installation of original or replacement shades. This Limited Lifetime Warranty does not cover damage or defects caused by, or resulting from improper maintenance, neglect or improper use, wear and tear, abuse, neglect, accidents, alteration, commercial use, installation, removal or reinstallation or exposure to excessive moisture.

Your Rights Under State Law

These warranties give you specific legal rights. You may also have other rights which may vary from State to State. In no event shall Pro Design LLC be liable for incidental or consequential damages or for any other direct or indirect damage, loss, cost, expense or fee. Some states do not allow the exclusion or limitation of incidental or consequential damages, so the above limitation or exclusion may not apply to you. These warranties are exclusive and in lieu of all other obligations, liabilities, disclaimers or warranties.

Please contact Customer Service with any question or concern:

e-mail: inspired@prodesignllc.net

call: 888-482-4082

Roller Fabric Sliding Panels Installation Instructions

Thank you for purchasing your roller fabric sliding panels. With proper installation your shade should look beautiful and provide years of service. Please check all parts and read these instructions before starting installation. Please keep the packaging until you have installed your shade and are satisfied with it.

TOOLS THAT MAY BE REQUIRED:

Pencil, Tape Measure, Screw Driver, Step Stool, Level, and Drill

NOTE: For wallboard or plaster use anchors designed for hollow walls (not included). For concrete, stone or brick, use a masonry drill bit and anchors designed for masonry (not included).

Sliding Panel Shipments:

Sliding panels are shipped in two parts:

- Panels and Valances
- Tracks

Please ensure you have both pieces of your shipment *before* installation.

Spliced Tracks:

If you ordered a sliding panel wider than 90 inches, the track will have been supplied to you in two pieces, with a splicing piece to join the two halves. The splicing piece will already have been installed in one half of the track [Figure 1]. Simply slide the other half of the track onto the exposed end of the splicing piece until the two halves fit snugly together [Figure 2].

Use installation brackets on either side of the splice to secure both parts of the track.

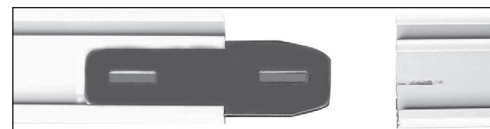

Figure 1: Spliced Track



Figure 2: Connected Spliced Track

STEP 1: Install Brackets

Depending on the size of your track and your mounting application, you will have received small (2-3 channel tracks) or a large (4-5 channel tracks) top or face mount swivel installation brackets [Figures 3-6].

For top mount, you will install the swivel brackets directly to the mounting surface.

1. Measure 4 inches in from each end of the window and ensure you have the following clearance from the window or from any protruding window hardware:
Small Bracket: 1 ¼" from the hole of the bracket.
Large Bracket: 2" from the hole of the bracket.
2. Make a pencil mark through the hole in the center of the bracket.
3. Space any additional brackets evenly between the two end brackets.
4. Drill holes through the pencil marks and using the correct anchors for your mounting surface, attach the brackets to the mounting surface. The arm of the bracket should be in the open position.

For face mount, you will use L-brackets to attach the swivel to the wall.

1. Mark with a pencil the desired height of the L-bracket, based on the length of panels you ordered. Then measure in 4" from the ends of the track.
2. Space any additional L-brackets evenly between the two end brackets. Use a level to make sure all brackets are even. Uneven brackets may stop the brackets engaging properly with the track.
3. Drill holes through the pencil marks and using the correct anchors for your mounting surface, attach the brackets to the mounting surface. The arm of the bracket should be in the open position.

Track Installation Brackets:

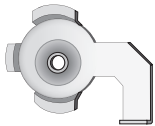

Figure 3: Small Top Mount

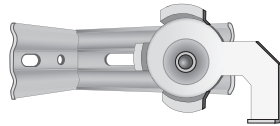

Figure 5: Small Face Mount

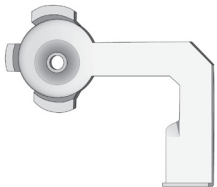

Figure 4: Large Top Mount

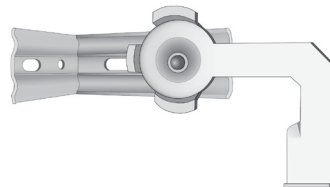

Figure 6: Large Face Mount

If you are installing with an Inspired Box Valance, move on to step 2.
If you are installing without a valance, move on to step 3.

STEP 2: Assemble and Install Inspired Box Valance

For top mount, check your mounting depth to make sure there is enough space to mount your sliding panel and valance. Valances are ½" thick.

1. Install L-brackets to box valance [Figure 7]. Valances should have L-brackets installed on either side and any additional brackets evenly spaced for support.
2. Install Box Valance by drilling directly through the L-brackets into the mounting surface.

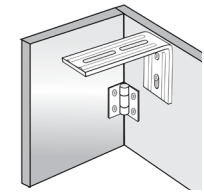

Figure 7: Box Valance L-Bracket

For face mount, install Inspired Box Valance L brackets to the sliding panel mounting bracket.

1. To attach Box Valance L brackets, check the installation location of the sliding panel brackets. Attach L-brackets to the Box Valance so they align with the location of the sliding panel brackets.
2. Using the nut and bolt provided, attach the Box Valance to the sliding panel bracket [Figure 8].

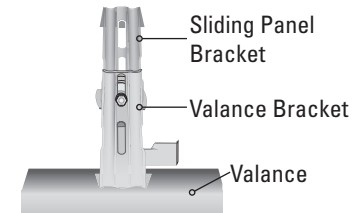

Figure 8: Box Valance Installed (face mount)

STEP 3: Install Track

1. With swivel brackets in the open position, place track against the brackets and rotate the swivel right to secure the track in place [Figure 9].

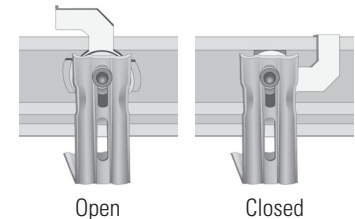

Figure 9: Track Installed

STEP 4: Install Panels

Secure the panels to the hangers with the velcro provided. Take care to position the panels so that the velcro engages fully and the panel is level. Repeat with all panels [Figure 10].

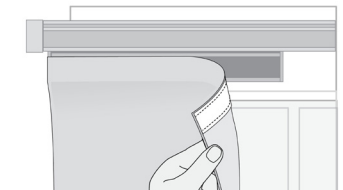

Figure 10: Panels Installed